

Component Placing Repair Drawing Electrical/1078-2/FEA 209 544/112, Electrical

Applicable for K790 and K800

Contents

1	Mounting drawing table	2
2	K790 – Primary side	3
3	K790 – Secondary side	4
4	K800 – Primary side	5
5	K800 – Secondary side	6
6	Revision history.....	7

1 Mounting drawing table

Board Number	Drawing	Comments
ROA 128 1834		K790
ROA 128 1534		K800

By using the “Search” function and enter the component name you can find the position of the component (Use Adobe Reader 7.0 or a later version). Example: You can see the component name highlighted on the circuit board (use zoom to enlarge).

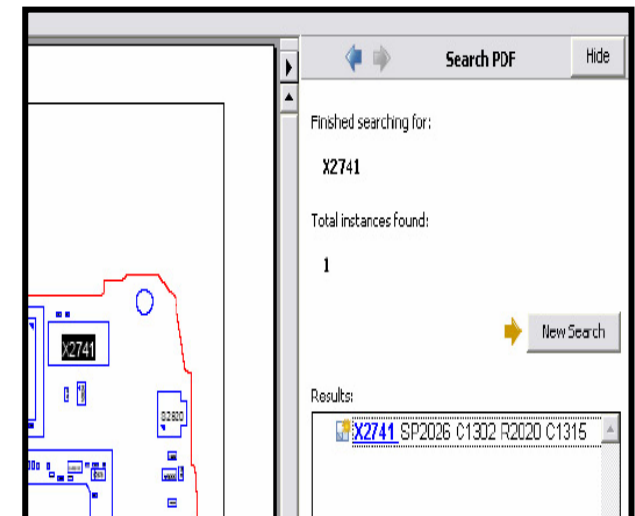
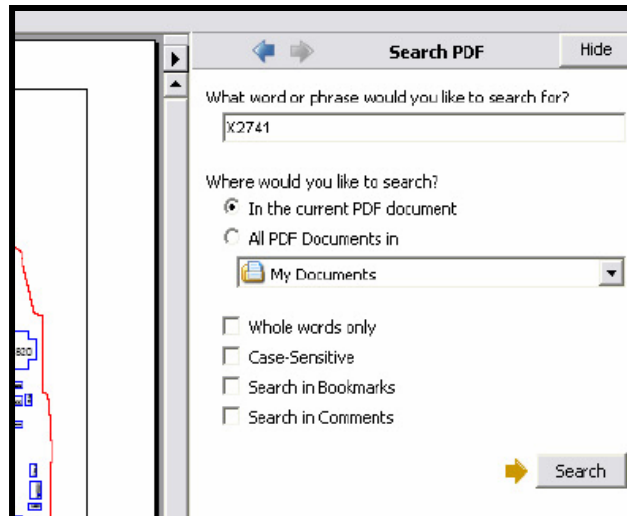

K790 - Primary side

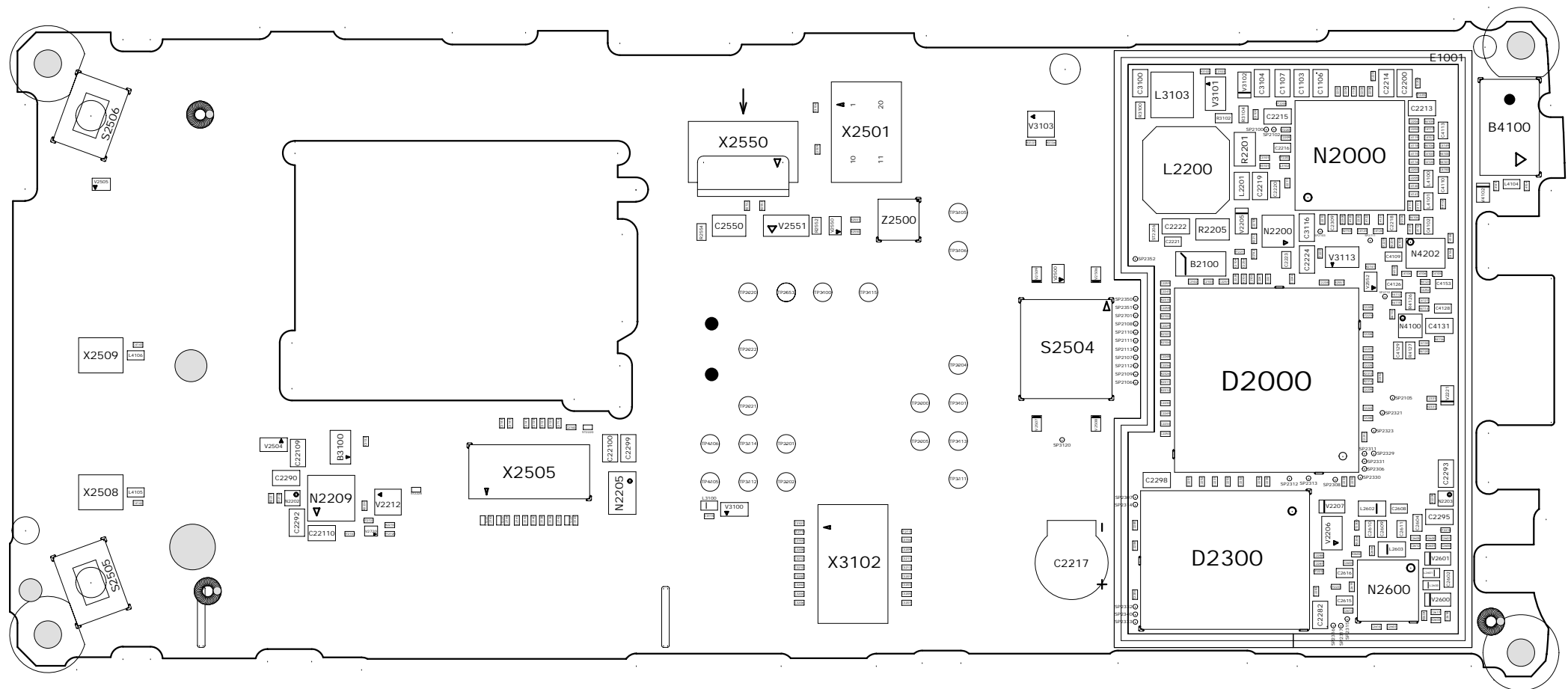

K790 - Secondary side

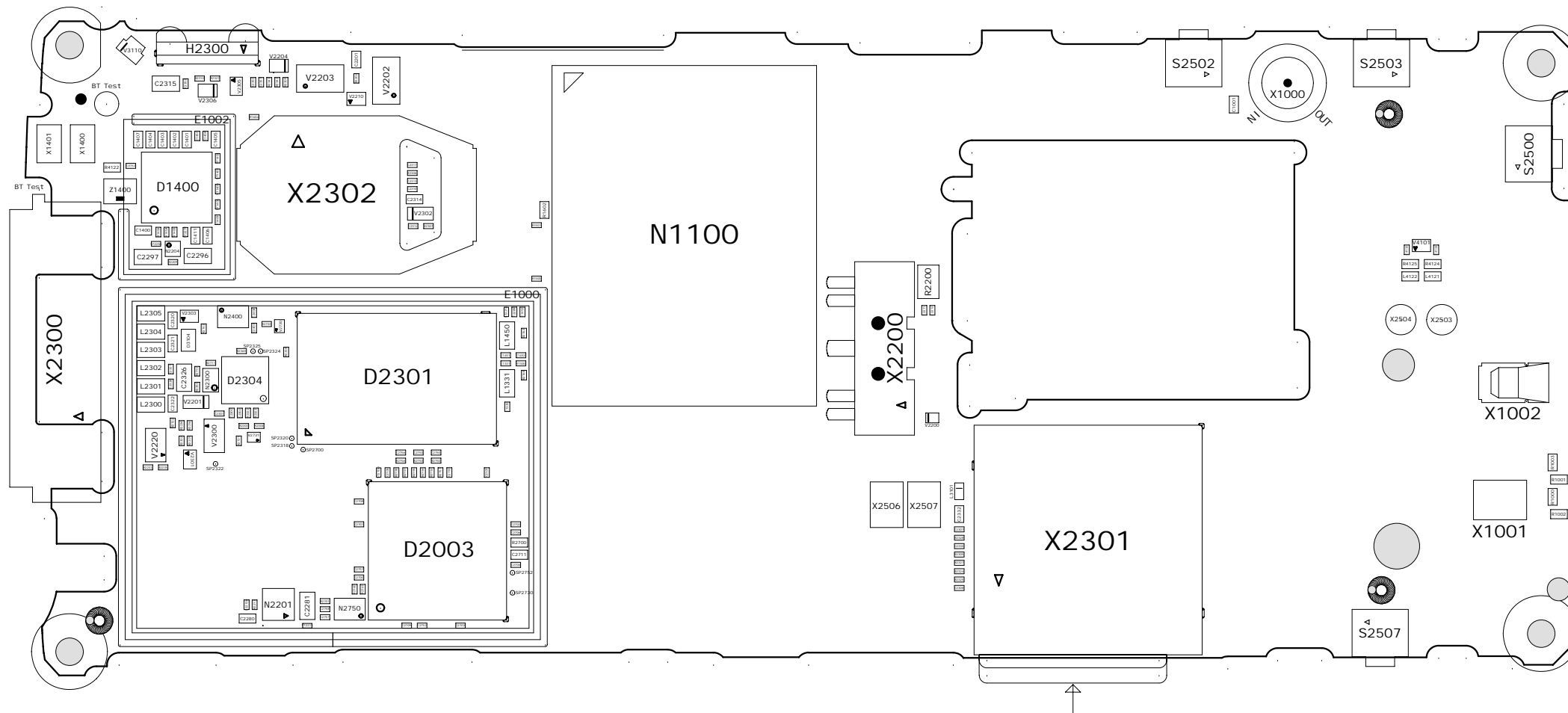

K800 - Secondary side

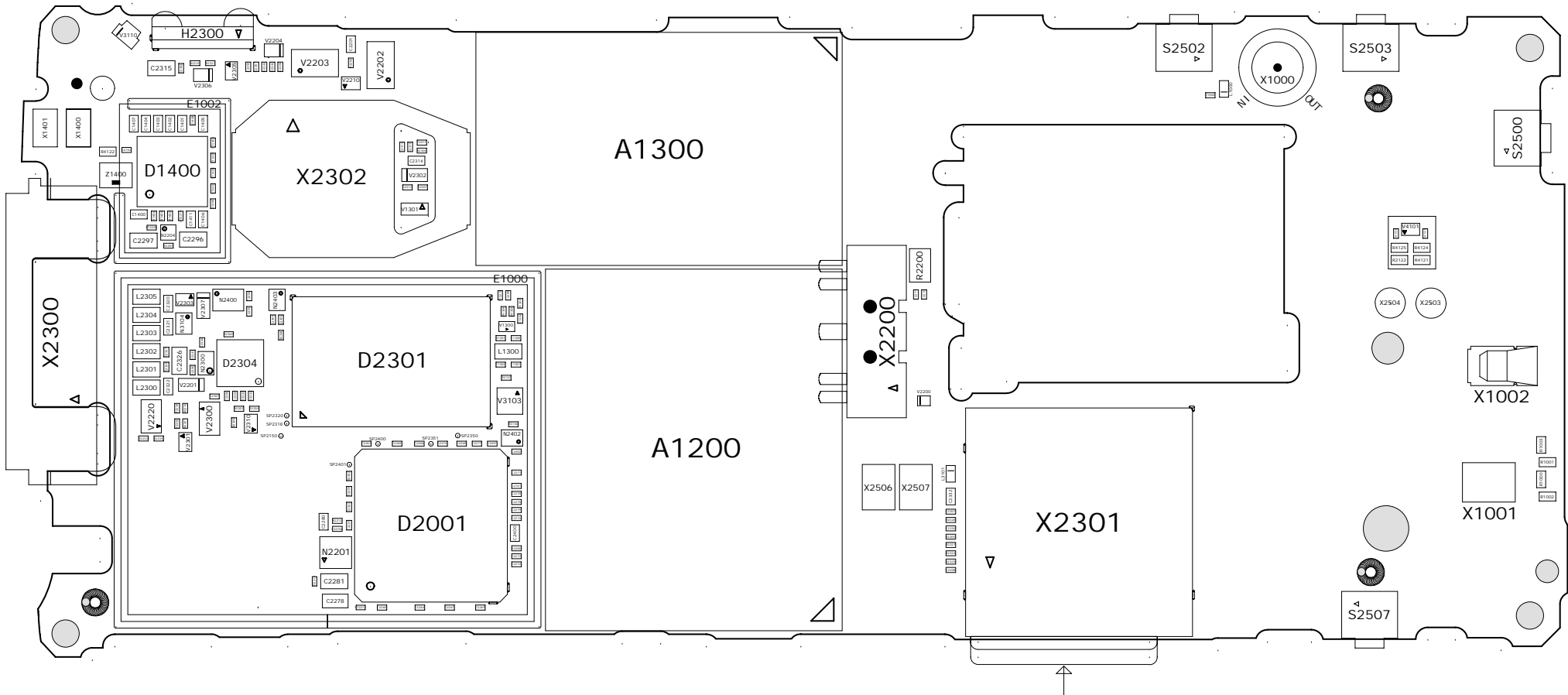

Revision history

Rev.	Date	Changes / Comments
A	2007-10-11	Initial release
2	2007-06-19	No changes made
3	2008-03-28	Due to system error, no changes made in content
4	2008-07-10	Corrected in K800 Primary side